

MARVELLA
samvrudhi

Home is where
Prosperity Blossoms
and
Comfort Blooms.





PROJECT BY
MARVELLA
BUILDTECH

#299
MARVELLA
SAMVRUDHI

Front Elevation

Your Path to Prosperity Begins here....

Indulge in the epitome of luxury and experience the prosperity you truly deserve at **"Marvella Samvrudhi."** Immerse yourself in a world of comfort and great architecture that you've always yearned for. If you've been dreaming of a life filled with opulence and trust-worthy constructions, **'Marvella Samvrudhi'** is your gateway to realizing those aspirations. This exceptional project, meticulously crafted by **MARVELLA BUILDTECH PVT LTD**, promises to be the ultimate luxury landmark in the heart of **Bengaluru's Jayanagar 2nd Block.**

'Marvella Samvrudhi' enjoys a prime location, offering you unparalleled convenience and easy access to all the city's amenities. This haven of prosperity is designed to provide you with modern comforts and conveniences that define a luxurious lifestyle.



“Building Excellence, Inspiring Trust.”

At **Marvella Buildtech Pvt. Ltd.**, we are committed to enhancing lives through our dedication to great architecture and unwavering trust-worthy constructions. We believe that prosperity and comfort should be the cornerstones of your living experience. Our **customer-centric** approach ensures that we continually meet and exceed your expectations, making **MARVELLA** homes the epitome of trust and luxury.

Our collaboration with renowned experts in the construction sector ensures that each project is a masterpiece of architecture and a testament to our commitment to quality. With **Marvella Buildtech Pvt. Ltd.**, you're not just buying a home; you're investing in a life filled with prosperity, comfort, great architecture, and **trust-worthy** constructions, where your dreams come to life.

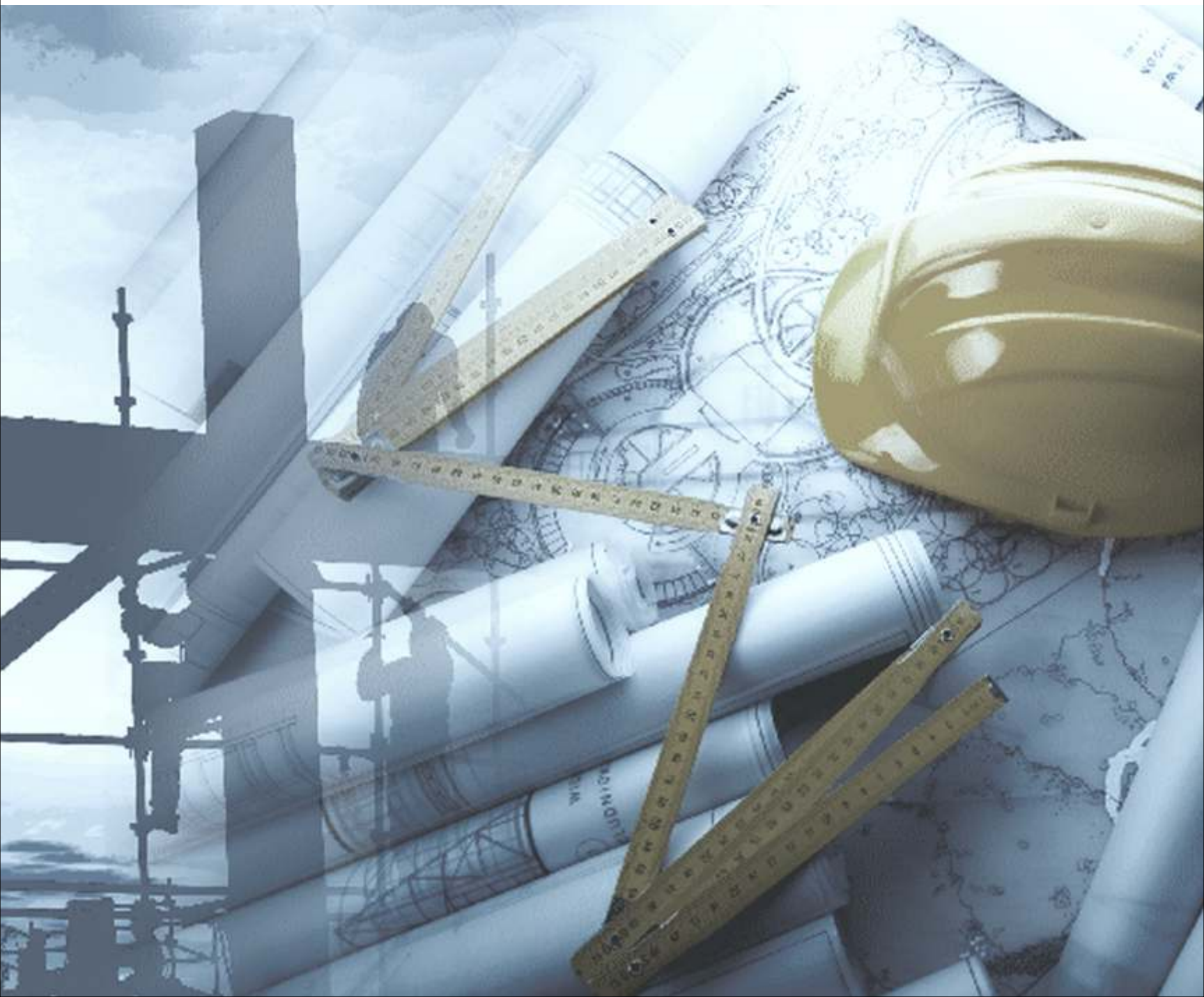



Typical Floor Plan

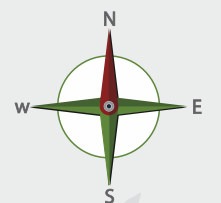

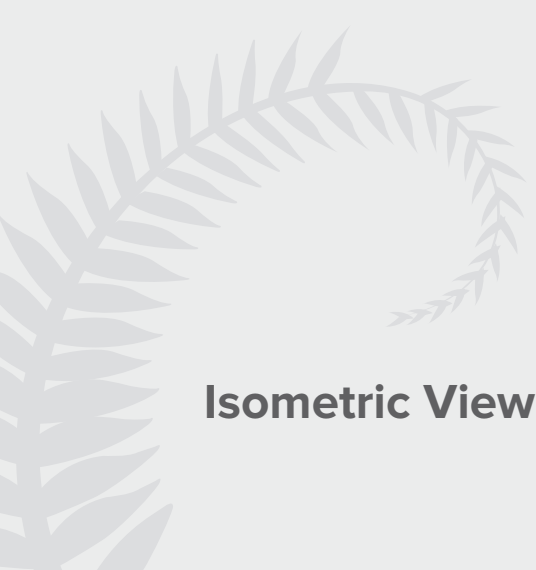

Isometric View





Isometric View



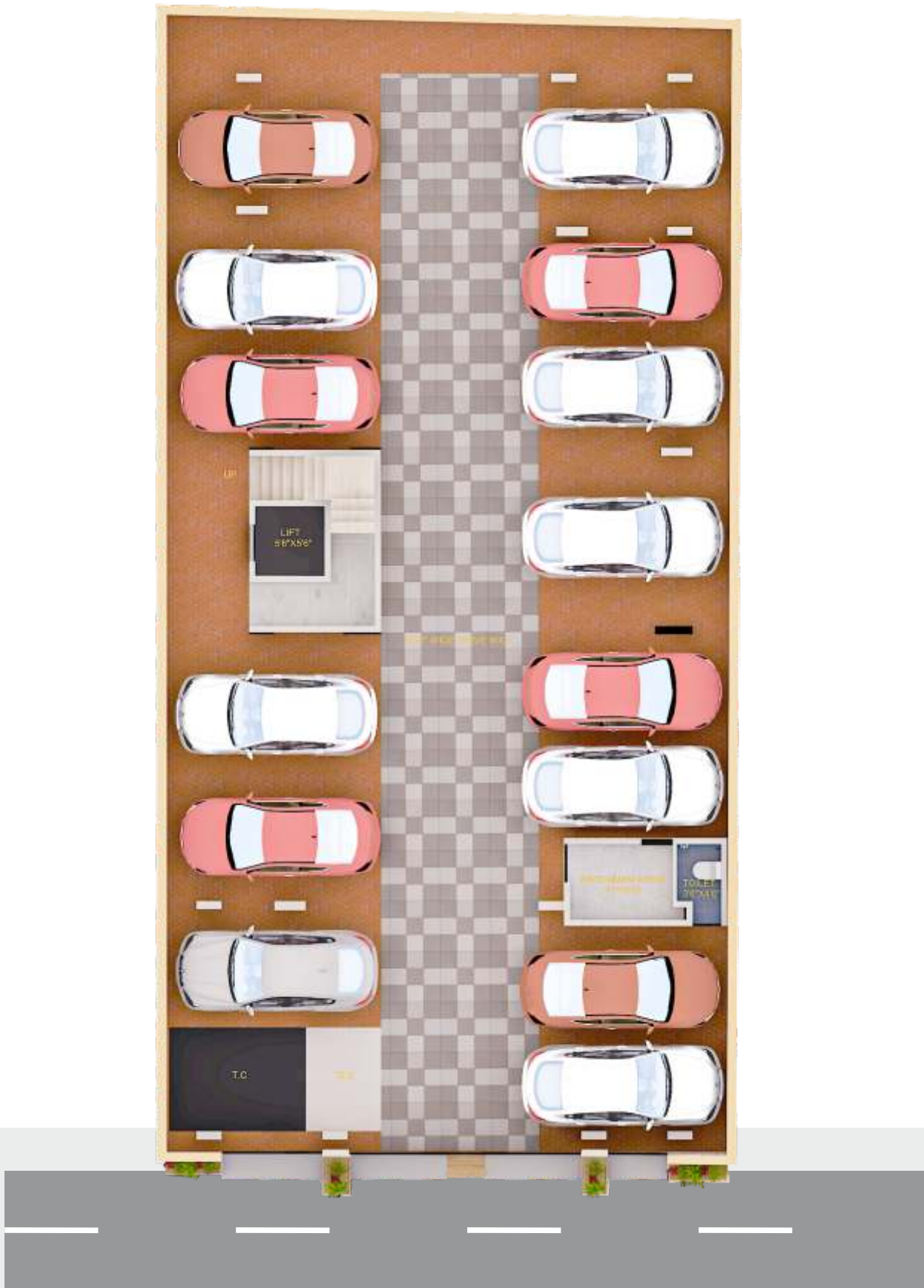

Typical Car Parking

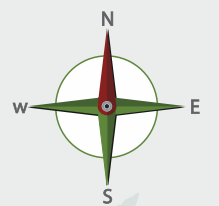

Specifications



Foundation & Super Structure :
RCC footings with framed structure.
Internal/external walls:
Solid concrete block masonry.
Roof slab: reinforced cement concrete
slab with waterproofing



Painting : Interior walls
Ceilings : Asian Premium Emulsion paint.
Exterior walls: Asian Apex weather proof paint.



Sanitary & Bathroom Fixtures
Wall mounted western commode
in all toilets.
Jaguar/Grohe fixtures for all toilets.
Health faucet for all toilets.
Shower in all toilets.
Provision for geyser and exhaust fan.



Safety Surveillance
Round the clock security.
CCTV Surveillance at
common areas & Parking.



Kitchen :
Granite top platform with
Carysil sink and 4 feet height glazed
tiles above platform Consolidated Gas
pipe lining for each house.



Lift Facility: Fully Automated 6
passengers capacity lift
Johnson / Kone / Otis
premium category.



Windows &
Ventilators: Teak wood frame
with teakwood
shutters.



Doors : Main Door & Pooja Room
: Teak wood frame with Solid
Teakwood shutters.
Internal doors : Teak wood frame with veener finish flush
shutters.
Toilet doors : Teak wood frame with veener finish flush
shutters.



Water Supply :
Sufficient Borewell & Kaveri Water supply.



Finishes /
Floorings : Living / Dining /
Kitchen : Italian Marble Flooring
Master
bedroom : Laminated wooden flooring
Bed rooms : Vitrified tile flooring
Utility : Anti skid Vitrified tiles
Toilets : Anti skid designer ceramic tiles.
Balcony : Anti skid ceramic tiles.
Common areas: Granite Flooring



Car Parking :
Covered Car parking in
basement, for each flat



Generator Backup:
Sound proof
generator with 1 kva electricity backup
for all flats & common area



Electrical Work :
Concealed Fire resistant copper
wiring with adequate light, Fan and Power points,
Telephone and T.V. Points in living and
master bed room with A.C.
provision for all bedrooms.
Wi-fi connection provision for living & Master bedroom.



Dadoing
Toilets : Ceramic glazed tiles
dado upto ceiling height.
Utility : Ceramic tiles upto 5 feet
height.



Re-cycling & Energy Saving Features :
Rainwater Harvesting, Provision for
Solar Water Heaters, Energy Saving
LED lights for common areas.



Electrical Vehicle Charging Point
(EV Station) At Parking area for
Individual Parking.



100% Vaastu compliance

LOCATION MAP



In the Neighbourhood...

Southend Metro	1.5 km	Basavanagudi	2.3 km
Jayanagar 4th Block Shopping Complex	2.0 km	Southend Circle	1.1 km
Cosmopolitan Club & Jayanagar Swimming Pool	1.3 km	Ashoka Pillar	0.5 km
Swagath Garudha Mall	2.2 km	Gandhi Bazaar	2.6 km
Jayanagar 9th Block Market	3.3 km	Lalbagh	0.5 km

Jayanagar, an upscale locality of South Bengaluru

Jayanagar, in South Bengaluru, is a prestigious residential and commercial hub. It's one of the city's oldest and most affluent neighborhoods, known for its well-planned layout, wide roads, and top-notch amenities.

Jayanagar features upscale residential areas alongside retail and commercial spaces. The 3rd and 4th blocks are bustling with shopping complexes, markets, high-end restaurants, and street vendors. It offers access to excellent hospitals, schools, and a variety of services.

This locality retains the charm of old Bengaluru while benefiting from modern conveniences. It also boasts a metro station on the Green Line, providing easy connectivity to key areas like BTM

Layout, VV Puram, Banashankari, JP Nagar, Basavangudi, and Wilson Garden. The well-connected bus station and metro make it convenient for residents to travel in all directions.

Jayanagar is a peaceful, green, and family-friendly neighborhood, easily accessible by bus, auto, and taxi. It's a place where the best of both worlds come together – old-world charm and modern convenience.

'**Marvella Samvrudhi**' enjoys a prime location, offering you unparalleled convenience and easy access to all the city's amenities. This haven of prosperity is designed to provide you with modern comforts and conveniences that define a luxurious lifestyle.



COMPLETED PROJECTS



SHAMBHAVI ELEGANCE
8TH BLOCK, JAYANAGAR



ASHIRWAD ELEGANCE
SBM COLONY, GIRINAGAR



SWASTIK ELEGANCE
MIDDLE SCHOOL ROAD, VV PURAM.



RAJKAMAL ELEGANCE
9TH BLOCK, JAYANAGAR

ONGOING PROJECT



SAI KRUPA ELEGANCE
7TH BLOCK JAYANAGAR



MARVELLA SUKRITI
BASAVANAGUDI



MARVELLA GOKULAM
7TH BLOCK, JAYANAGAR



**MARVELLA
BUILDTECH**

Marvella Buildtech Pvt Ltd

770, Vasavi Classic, 3rd Floor, 10th Main, 4th Block Jayanagar,
Bangalore – 560 011. Ph : 080 - 4374 4499,
Email : info@marvellaglobal.com

Project Address :

299, 10th B Main Road, 1st block jayanagar, Bangalore - 560011

Gopi Ganesh : +91 99454 44599

Nikil Hari : +91 97422 95890

SCAN TO LOCATE
THE PROJECT

